

# *Short Form Specification*

## **Beck Compact Module SCM24H01-R RGB/DVI**



December 2013

**Preliminary**

The information given in this document is carefully checked and believed to be reliable. However, Beck GmbH & Co. Elektronik Bauelemente KG takes no responsibility for any failure or product damage caused by application of this information. Please check all connections carefully with the product specification.

Products of Beck Elektronik are not intended for use in systems in which failures of product could result in personal injury. All mentioned trademarks are registered trademarks of their owner.

This specification is subject to change without notification.

## 1. General Features

Item	Description	Unit
Diagonal	61.0 (24.0")	cm
Active area	531.36 (H) x 298.89 (V)	mm
Resolution – display	1920 (x3) x 1080	pixel
Resolution – controller	640 x 480 – 1920 x 1080	pixel
Pixel pitch	0.277 (per one traid) X 0.277	mm
Pixel arrangement	R.G.B. Vertical Stripe	
Display colors	16,7 M	colors
Display mode	VA Mode, Normally Black	
Brightness	300	cd/m <sup>2</sup>
Contrast ratio	5000:1	
Viewing angle	hor.: 89° / 89°, ver.: 89° / 89°	deg.
Response time	25	msec
LED Backlight life	min 50,000	hrs
Interface	Analog-RGB H-Sync. / V-Sync. // DVI	
Touch	Not available	
Power input voltage	12	V DC
Power consumption	33	W
Dimension	578.30 x 345.50 x 32.00	mm
Weight	4,000	gram
VPE	4	
Remark	wide view (MVA) / LED	

### Power Input Connector

Type: DC Jack

Pin No.	Symbol	Description	Note
1	Vin	12V DC	Center
2	GND	GND	

**Figure 1: Mechanical Outlines**

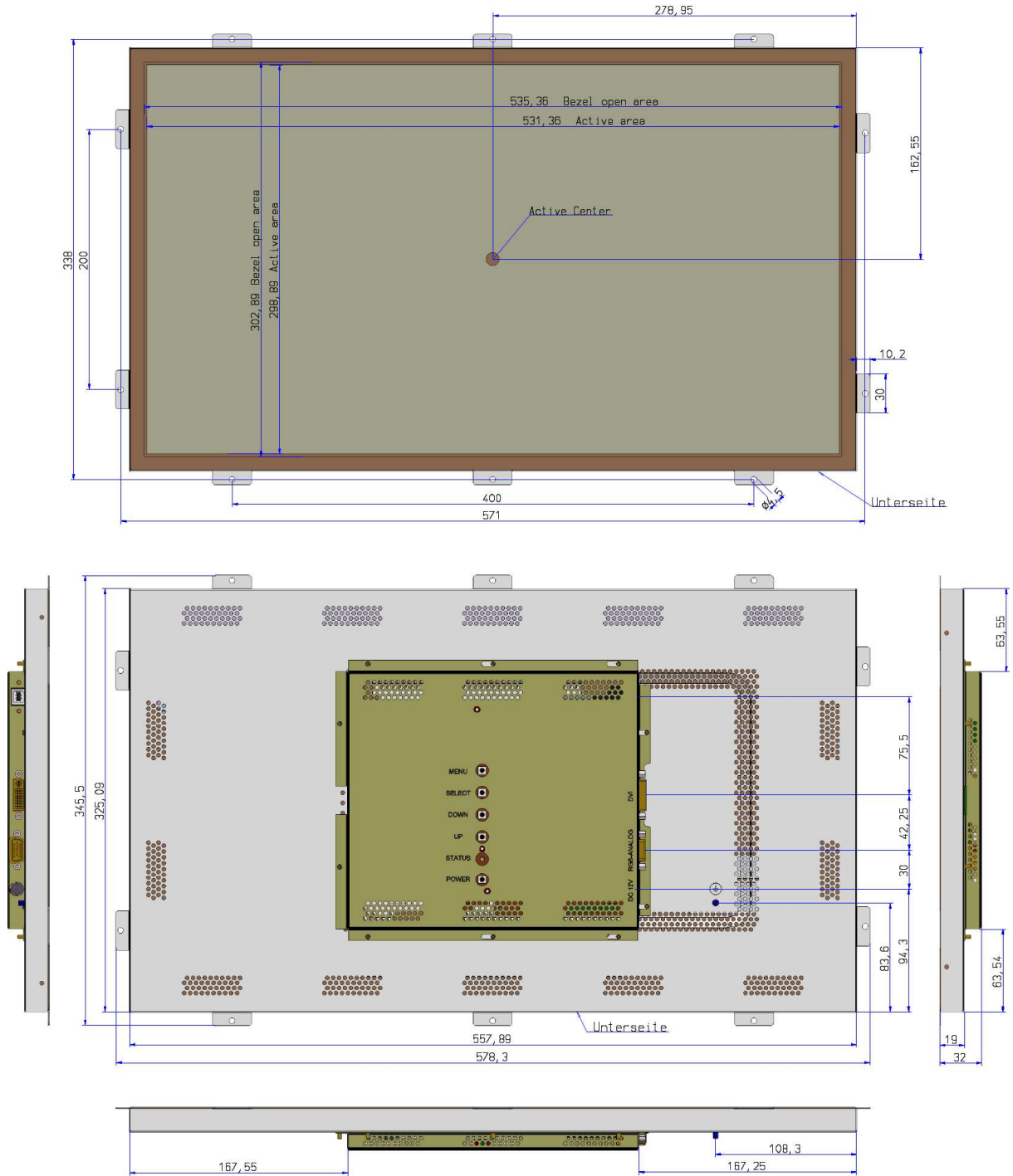

## 2. Handling & Cautions

### Cautions when taking out the module

- Pick the pouch only, when taking out module from a shipping package.

### Cautions for handling the module

- As the electrostatic discharges may break the LCD module, handle the LCD module with care. Peel a protection sheet off from the LCD panel surface as slowly as possible.
- As the LCD panel and backlight element are made from fragile glass material, impulse and pressure to the LCD module should be avoided.
- As the surface of the polarizer is very soft and easily scratched, use a soft dry-cloth without chemicals for cleaning.
- Put the module display side down on a flat horizontal plane.
- Handle connectors and cables with care.

### Cautions for the atmosphere

- Dewdrop atmosphere should be avoided.
- Do not store and/or operate the LCD module in a high temperature and/or humidity atmosphere. Storage in an electro-conductive polymer-packing pouch and under relatively low temperature atmosphere is recommended.

### Cautions for the module characteristics

- Do not apply fixed pattern data signal to the LCD module at aging time.
- Applying fixed pattern for a long time may cause image sticking.

### Other cautions

- Do not disassemble and/or re-assemble LCD module.
- Do not re-adjust variable resistor or switch etc.
- When returning the module for repair or etc., please pack the module not to be broken. We recommend on using the original shipping packages.

## 3. Packing Information

Each of the four SCM24H01-R is packed into an anti-static foil. These four units of SCM24H01-R are packed into a carton filled and cushioned with shock absorbing carton and therefore good protected for shipping on euro pallet.

## 4. Optional Accessories

We refer to our webpage:

<http://beck-oled-lcd-tft-display.de/index.php?id=bcm-standard-line>

We offer a wide variety of optional accessories to operate the SCM24H01-R.